



DANMWO32L
MICROWAVE OVEN
Appliance User Manual

danielaappliances.com.au



Daniela Appliances started in 1988. Formally known as Italnova, the company began operating by selling other major leading brands. Since then, Daniela Appliances has its own range, continuously evolving, striving on delivering leading-edge quality products at very competitive prices.

From an Italian heritage our brand Daniela was then established in 2005 from a father's love to a daughter and naming it after Daniela, now the new proprietor. Daniela has worked closely with her father for many years learning from his decades of industry experience. Daniela with her extensive knowledge and understanding of appliances, now continues her father's legacy with a modern flare.

Our products are extensively tested and come with ISO certification certificates prior to importation. Daniela Appliances continuously designs and sources the best parts, to bring you an elegant feel that will last the test of time and for a third of the cost from a major brand.

Daniela Appliances is dedicated to offering our customers exceptional products with exceptional service. Our commitment is to provide our valuable customers the very best in technology with the very best in safety that combines both the values that brings us market success.



DANMWO32L MICROWAVE OVEN



TECHNICAL SPECIFICATION

MODEL	DANMWO32L
Rated Voltage	230-240V~50Hz
Rated Input Power (Microwave)	1550W
Rated Output Power (Microwave)	1000W
Rated Input Power (Grill)	1100W
Rated Input Power (Convection)	2300W
Oven Capacity	32L
Turntable Diameter	Ø315mm
External Dimensions (L x D x H)	594 x 468.2 x 388mm
Net Weight	Approx. 22.1kg



SAVE THIS INSTRUCTION IN A SAFE PLACE FOR FUTURE REFERENCE

Thank you for choosing Daniela appliances!

Please read all instructions before using this appliance. This book contains valuable information about operation, care and service. Keep it in a safe place for future reference. Should the appliance be sold or transferred to another owner, or should you move house and leave the appliance, always ensure that the book is supplied with the appliance in order that new owner can be acquainted with the functioning of the appliance and relevant warnings.

The manufacturer cannot be held responsible for any inaccuracies due to printing or transcription errors that may be found in this handbook.

N.B.: the pictures shown in the figures in this manual are purely indicative.

PRECAUTIONS TO AVOID POSSIBLE EXPOSURE TO EXCESSIVE MICROWAVE ENERGY

- (a) Do not attempt to operate this oven with the door open since this can result in harmful exposure to microwave energy. It is important not to break or tamper with the safety interlocks.
- (b) Do not place any object between the oven front face and the door or allow soil or cleaner residue to accumulate on sealing surfaces.
- (c) **WARNING:** If the door or door seals are damaged, the oven must not be operated until it has been repaired by a competent person.

ADDENDUM

If the apparatus is not maintained in a good state of cleanliness, its surface could be degraded and affect the lifespan of the apparatus and lead to a dangerous situation.

IMPORTANT SAFETY INSTRUCTIONS

To reduce the risk of fire, electric shock, injury to persons or exposure to excessive microwave oven energy when using your appliance, follow basic precautions, including the following:

- 1. Warning: Liquids and other foods must not be heated in sealed containers since they are liable to explode.
- 2. Warning: It is hazardous for anyone other than a competent person to carry out any service or repair operation that involves the removal of a cover which gives protection against exposure to microwave energy.



- 3. This appliance can be used by children aged from 8 years and above and persons with reduced physical, sensory or mental capabilities or lack of experience and knowledge if they have been given supervision or instruction concerning use of the appliance in a safe way and understand the hazards involved. Children shall not play with the appliance. Cleaning and user maintenance shall not be made by children unless they are older than 8 and supervised.
- 4. Keep the appliance and its cord out of reach of children less than 8 years.
- 5. Only use utensils suitable for use in microwave ovens.
- 6. The oven should be cleaned regularly and any food deposits should be removed.
- 7. Read and follow the specific: "PRECAUTIONS TO AVOID POSSIBLE EXPOSURE TO EXCESSIVE MICROWAVE ENERGY".
- 8. When heating food in plastic or paper containers, keep an eye on the oven due to the possibility of ignition.
- 9. If smoke is emitted, switch off or unplug the appliance and keep the door closed in order to stifle any flames.
- 10. Do not overcook food.
- 11. Do not use the oven cavity for storage purposes. Do not store items, such as bread, cookies, etc. inside the oven.
- 12. Remove wire twist-ties and metal handles from paper or plastic containers/bags before placing them in the oven.
- 13. Install or locate this oven only in accordance with the installation instructions provided.
- 14. Eggs in the shell and whole hard-boiled eggs should not be heated in microwave ovens since they may explode, even after microwave heating has ended.
- 15. This appliance is intended to be used in household and similar applications such as:
 - staff kitchen areas in shops, offices and other working environments;
 - by clients in hotels, motels and other residential type environments;
 - farm houses;
 - bed and breakfast type environments.
- 16. If the supply cord is damaged, it must be replaced by the manufacturer, its service agent or similarly qualified persons in order to avoid a hazard.
- 17. Do not store or use this appliance outdoors.
- 18. Do not use this oven near water, in a wet basement or near a swimming pool.
- 19. The temperature of accessible surfaces may be high when the appliance is operating. The surfaces are liable to get hot during use. Keep cord away from heated surface, and do not cover any vents on the oven.



20. Do not let cord hang over edge of table or counter.
21. Failure to maintain the oven in a clean condition could lead to deterioration of the surface that could adversely affect the life of the appliance and possibly result in a hazardous situation.
22. The contents of feeding bottles and baby food jars shall be stirred or shaken and the temperature checked before consumption, in order to avoid burns.
23. Microwave heating of beverages can result in delayed eruptive boiling, therefore care must be taken when handling the container.
24. The appliance is not intended for use by persons (including children) with reduced physical, sensory or mental capabilities, or lack of experience and knowledge, unless they have been given supervision or instruction concerning use of the appliance by a person responsible for their safety.
25. Children should be supervised to ensure that they do not play with the appliance.
26. The appliances are not intended to be operated by means of an external timer or separate remote-control system.
27. Accessible parts may become hot during use. Young children should be kept away.
28. Steam cleaner is not to be used.
29. During use the appliance becomes hot. Care should be taken to avoid touching heating elements inside the oven.
30. Only use the temperature probe recommended for this oven.(for ovens provided with a facility to use a temperature-sensing probe).
31. **WARNING:** The appliance and its accessible parts become hot during use. Care should be taken to avoid touching heating elements. Children less than 8 years of age shall be kept away unless continuously supervised.
32. The microwave oven must be operated with the decorative door open (for ovens with a decorative door).
33. Surface of a storage cabinet can get hot.



TO REDUCE THE RISK OF INJURY TO PERSONS GROUNDING INSTALLATION

DANGER: ELECTRIC SHOCK HAZARD

- Touching some of the internal components can cause serious personal injury or death. Do not disassemble this appliance.

WARNING: ELECTRIC SHOCK HAZARD

- Improper use of the grounding can result in electric shock. Do not plug into an outlet until appliance is properly installed and grounded.
 - This appliance must be grounded. In the event of an electrical short circuit, grounding reduces the risk of electric shock by providing an escape wire for the electric current. This appliance is equipped with a cord having a grounding wire with a grounding plug. The plug must be plugged into an outlet that is properly installed and grounded.
 - Consult a qualified electrician or serviceman if the grounding instructions are not completely understood or if doubt exists as to whether the appliance is properly grounded. If it is necessary to use an extension cord, use only a 3-wire extension cord.
1. A short power-supply cord is provided to reduce the risks resulting from becoming entangled in or tripping over a longer cord.
 2. If a long cord set or extension cord is used:-
 - The marked electrical rating of the cord set or extension cord should be at least as great as the electrical rating of the appliance.
 - The extension cord must be a grounding-type 3-wire cord.
 - The long cord should be arranged so that it will not drape over the counter top or tabletop where it can be pulled on by children or tripped over unintentionally.

CLEANING

Be sure to unplug the appliance from the power supply.

1. Clean the cavity of the oven after using with a slightly damp cloth.
2. Clean the accessories in the usual way in soapy water.
3. The door frame and seal and neighbouring parts must be cleaned carefully with a damp cloth when they are dirty.



- 4. Do not use harsh abrasive cleaners or sharp metal scrapers to clean the oven door glass since they can scratch the surface, which may result in shattering of the glass.
- 5. **Cleaning Tip:** For easier cleaning of the cavity walls that the food cooked can touch: Place half a lemon in a bowl, add 300ml (1/2 pint) water and heat on 100% microwave power for 10 minutes. Wipe the oven clean using a soft, dry cloth.

CAUTION: PERSONAL INJURY HAZARD

It is hazardous for anyone other than a competent person to carry out any service or repair operation that involves the removal of a cover which gives protection against exposure to microwave energy.

UTENSILS

See the instructions on "Materials you can use in microwave oven or to be avoided in microwave oven." There may be certain non-metallic utensils that are not safe to use for microwaving. If in doubt, you can test the utensil in question following the procedure below.

Utensil Test:

- 1. Fill a microwave-safe container with 1 cup of cold water (250ml) along with the utensil in question.
- 2. Cook on maximum power for 1 minute.
- 3. Carefully feel the utensil. If the empty utensil is warm, do not use it for microwave cooking.
- 4. Do not exceed 1 minute cooking time.

MATERIALS TO BE AVOIDED IN MICROWAVE OVEN

UTENSILS	REMARKS
Aluminum tray	May cause arcing. Transfer food into microwave-safe dish
Food carton with metal handle	May cause arcing. Transfer food into microwave-safe dish.
Metal or metal-trimmed utensils	Metal shields the food from microwave energy. Metal trim may cause arcing.
Metal twist ties	May cause arcing and could cause a fire in the oven.
Paper bags	May cause a fire in the oven.
Plastic foam	Plastic foam may melt or contaminate the liquid inside when exposed to high temperature.
Wood	Wood will dry out when used in the microwave oven and may split or crack.



MATERIALS YOU CAN USE IN MICROWAVE OVEN

UTENSILS	REMARKS
Aluminum foil	Shielding only. Small smooth pieces can be used to cover thin parts of meat or poultry to prevent overcooking. Arcing can occur if foil is too close to oven walls. The foil should be at least 1 inch (2.5cm) away from oven walls.
Browning dish	Follow manufacturer's instructions. The bottom of browning dish must be at least 3/16 inch (5mm) above the turntable. Incorrect usage may cause the turntable to break.
Dinnerware	Microwave-safe only. Follow manufacturer's instructions. Do not use cracked or chipped dishes.
Glass jars	Always remove lid. Use only to heat food until just warm. Most glass jars are not heat resistant and may break.
Glassware	Heat-resistant oven glassware only. Make sure there is no metallic trim. Do not use cracked or chipped dishes.
Oven cooking bags	Follow manufacturer's instructions. Do not close with metal tie. Make slits to allow steam to escape.
Paper plates and cups	Use for short-term cooking/warming only. Do not leave oven unattended while cooking.
Paper towels	Use to cover food for reheating and absorbing fat. Use with supervision for a short-term cooking only.
Parchment paper	Use as a cover to prevent splattering or a wrap for steaming.
Plastic	Microwave-safe only. Follow the manufacturer's instructions. Should be labeled "Microwave Safe". Some plastic containers soften, as the food inside gets hot. "Boiling bags" and tightly closed plastic bags should be slit, pierced or vented as directed by package.
Plastic wrap	Microwave-safe only. Use to cover food during cooking to retain moisture. Do not allow plastic wrap to touch food.
Thermometers	Microwave-safe only (meat and candy thermometers).
Wax paper	Use as a cover to prevent splattering and retain moisture.



SETTING UP YOUR OVEN

Remove the oven and all materials from the carton and oven cavity.

Your oven comes with the following accessories:

- 1 x Glass tray
- 1 x Turntable ring assembly
- 1 x Instruction Manual

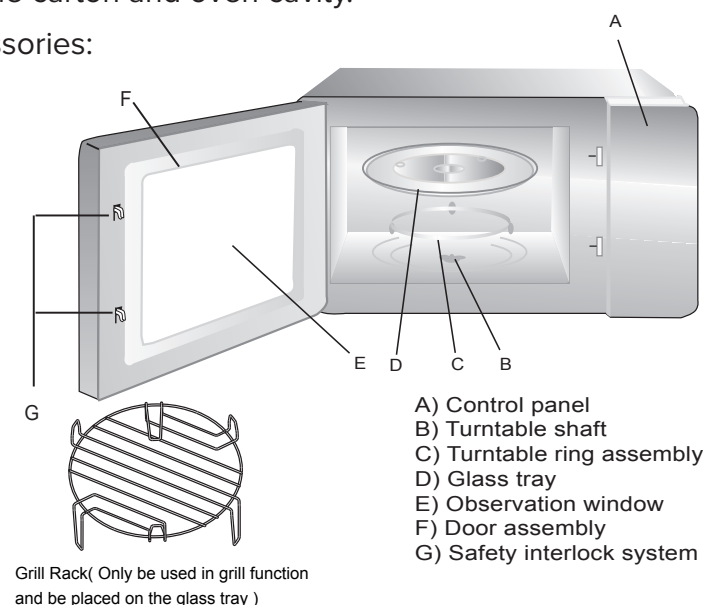

TURNTABLE INSTALLATION

- Never place the glass tray upside down. The glass tray should never be restricted.
- Both glass tray and turntable ring assembly must always be used during cooking.
- All food and containers of food are always placed on the glass tray for cooking.
- If glass tray or turntable ring assembly cracks or breaks, contact your nearest authorized service centre.

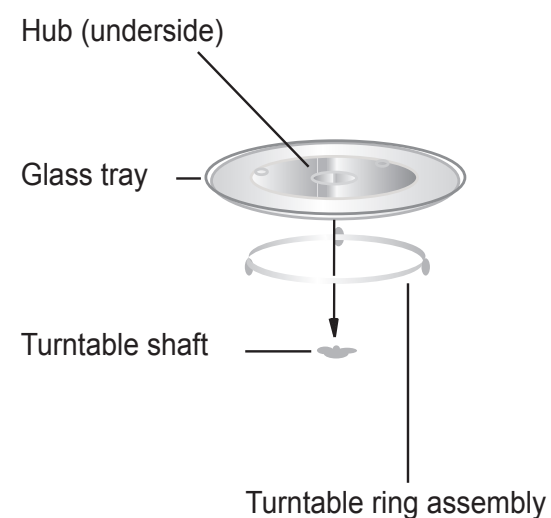

INSTALLATION AND CONNECTION

1. This appliance is only intended for domestic use.
2. This oven is intended for built-in use only. It is not intended for counter-top use or for use inside a cupboard.
3. Please observe the special installation instructions.
4. The appliance can be installed in a 60cm wide wall-mounted cupboard (at least 55cm deep and 85cm off the floor).
5. The appliance is fitted with a plug and must only be connected to a properly installed earthed socket.
6. The mains voltage must correspond to the voltage specified on the rating plate.
7. The socket must be installed and connecting cable must only be replaced by a qualified electrician. If the plug is no longer accessible following installation, an all-pole disconnecting device must be present on the installation side with a contact gap of at least 3mm.
8. Adapters, multi-way strips and extension leads must not be used. Overloading can result in a risk of fire.



The accessible surface may be hot during operation.

INSTALLATION INSTRUCTIONS

ELECTRICAL CONNECTION

- The oven is fitted with a plug and must be only connected to a properly installed earthed socket. In accordance with the appropriate regulations, the socket must only be installed and the connecting cable must only be replaced by a qualified electrician.
- If the plug is no longer accessible following installation and all-pole isolating switch must be present on the installation side with a contact gap of at least 3mm.

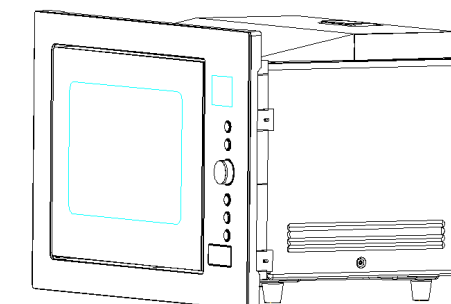



INSTALLATION INSTRUCTIONS

A. BUILT-IN FURNITURE

- The built-in cabinet shall not have a rear wall behind the appliance. Minimum installation height is 85cm.
- Do not cover ventilation slots and air intake points.

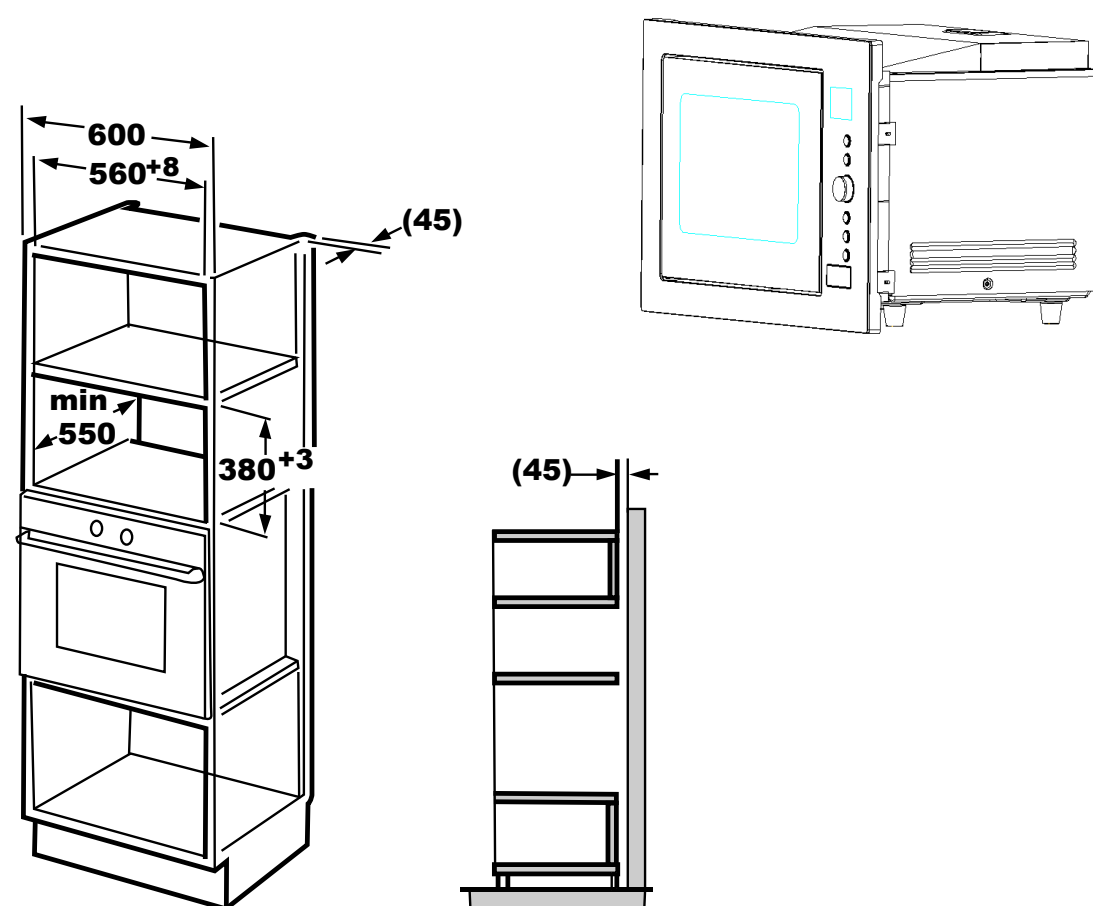

B. INSTALL THE OVEN

- Do not trap or kink the power cord.
- Make sure that the oven is installed in the center of the cabinet.

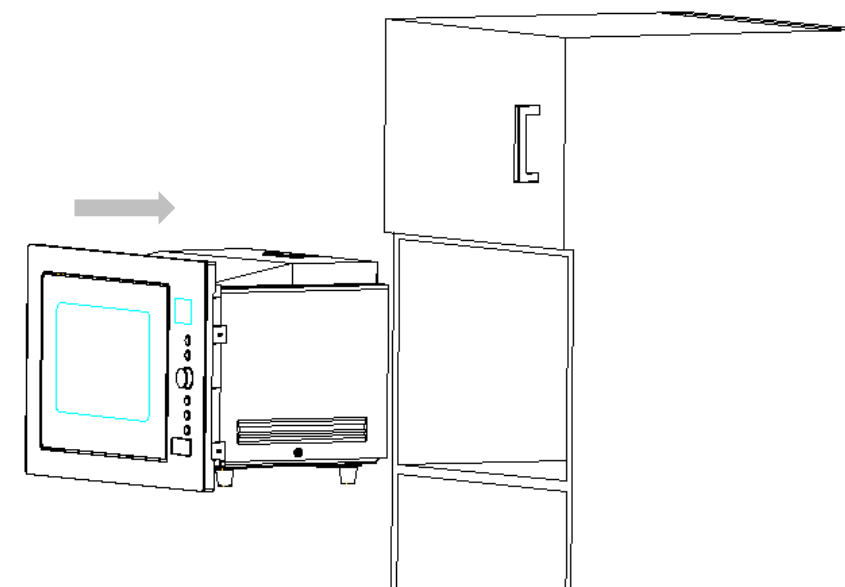

- Open the door; fix the oven to the cabinet with SCREW at the INSTALLATION HOLE of TRIM KIT. Then fix the TRIM-KIT PLASTIC COVER to the INSTALLATION HOLE.

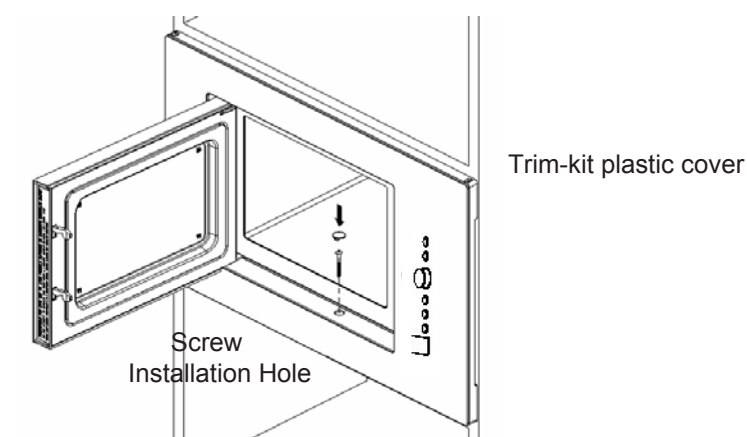



OPERATION INSTRUCTIONS

This microwave oven uses modern electronic control to adjust cooking parameters to meet your needs better for cooking.

1. CLOCK SETTING

- 1. In waiting state, press "KITCHEN TIMER/CLOCK" twice, "00:00" displays. Hour figures flash.
- 2. Turn "👉" to adjust the hour figures, the input time should be within 0-23.
- 3. Press "KITCHEN TIMER/CLOCK", the minute figures will flash.
- 4. Turn "👉" to adjust the minute figures, the input time should be within 0-59.
- 5. Press "KITCHEN TIMER/CLOCK" to finish clock setting. ":" will flash.

Note:

- If the clock is not set, the clock would not function when powered.
- During the process of clock setting, if you press "STOP/CLEAR", it will exit the setting state.

2. MICROWAVE COOKING

- 1. Press the "MICRO/GRILL /COMB I./CONVE." key once, and "P100" displays.
- 2. Press "MICRO/GRILL /COMB I./CONVE." for times or turn "👉" select the microwave power from 100% to 10%. "P100", "P80", "P50", "P30", "P10" ... will display in order.
- 3. Press "START/+30SEC./CONFIRM" to confirm.
- 4. Turn "👉" to adjust the cooking time. (The time setting should be 0:05-95:000).
- 5. Press "START/+30SEC./CONFIRM" to start cooking.

Note:

The step quantities for the adjustment time of the coding switch are as follows:

0-1 min : 5 seconds
1-5 min : 10 seconds
5-10 min : 30 seconds
10-30 min : 1 minute
30-95 min : 5 minutes

MICROWAVE POWER CHART

PRESS	1 Time	2 Times	3 Times	4 Times	5 Times
MICROWAVE POWER	100%	80%	50%	30%	10%



3. GRILL COOKING

- 1. Press the "MICRO/GRILL /COMB I./CONVE." key once, and "P100" displays.
- 2. Press "MICRO/GRILL /COMB I./CONVE." for times or turn "👉" to select the grill function. When "G-1" displays, it indicates grill function.
- 3. Press "START/+30SEC./CONFIRM" to confirm.
- 4. Turn "👉" to adjust the cooking time. (The time setting should be 0:05-95:00).
- 5. Press "START/+30SEC./CONFIRM" to start cooking.

Note:

If half the grill time passes, the oven will sound twice to tell you to turn over the food. You can just leave it continue. But in order to have a better effect of grilling food, you should turn the food over, close the door, and then press "START/+30SEC./CONFIRM" to continue cooking.

4. COMBINATION COOKING

- 1. Press the "MICRO/GRILL /COMB I./CONVE." key once, and "P100" displays.
- 2. Press "MICRO/GRILL /COMB I./CONVE." for times or turn "👉" to select the combination function. Stop turning when "C-1", "C-2", "C-3", "C-4" displays.
- 3. Press "START/+30SEC./CONFIRM" to confirm.
- 4. Turn "👉" to adjust the cooking time. (The time setting should be 0:05-95:00).
- 5. Press "START/+30SEC./CONFIRM" to start cooking.

COMBINATION INSTRUCTIONS

INSTRUCTIONS	DISPLAY	MICROWAVE	GRILL	CONVECTION
1	C-1	X		X
2	C-2	X	X	
3	C-3		X	X
4	C-4	X	X	X



5. CONVECTION COOKING (WITH PREHEATING FUNCTION)

1. Press the "MICRO/GRILL/COMB I./CONVE." key once, and "P100" displays.
2. Press "MICRO/GRILL /COMB I./CONVE." for times or turn "👉" to select the convection function. When convection temperature displays, it indicates convection function. The temperature can be chosen from 140 degrees to 230 degrees.
3. Press the "START/+30SEC./CONFIRM" to confirm the temperature.
4. Press the "START/+30SEC./CONFIRM" to start preheating. When the preheating temperature arrives, the buzzer will sound twice to remind you to put the food into the oven. And the preheated temperature is displayed and flash.
5. Put the food into the oven and close the door. Turn "👉" to adjust the cooking time. (The maximum setting time is 95 minutes).
6. Press the "START/+30SEC./CONFIRM" key to start cooking.

Note:

- Cooking time cannot be input until the preheating temperature arrives. If the temperature arrives, door must be opened to input the cooking time.
- If the time not input in 5 minutes, the oven will stop preheating. The buzzer sound five times and turn back to waiting states.

6. CONVECTION COOKING (WITHOUT PREHEATING FUNCTION)

1. Press the "MICRO/GRILL/COMB I./CONVE." key once, and "P100" displays.
2. Press "MICRO/GRILL /COMB I./CONVE." for times or turn "👉" to select the convection function. When convection temperature displays, it indicates convection function. The temperature can be chosen from 140 degrees to 230 degrees.
3. Press the "START/+30SEC./CONFIRM" to confirm the temperature
4. Turn "👉" to adjust the cooking time. (The maximum setting time is 95 minutes).
5. Press the "START/+30SEC./CONFIRM" key to start cooking.



7. MULTI-STAGE COOKING

Two stages can be maximumly set. If one stage is defrosting, it should be put in the first stage. The buzzer will ring once after each stage and the next stage will begin.

Note: Auto menu and preheating cannot be set as one of the multi-stage.

Example: if you want to defrost the food for 5 minutes, then to cook with 80% microwave power for 7 minutes. The steps are as following:

1. Press "WEIGHT /TIME DEFROST " twice, the screen will display "dEF2" ;
2. Turn "👉" to adjust the defrost time of 5 minutes;
3. Press "MICRO/GRILL /COMB I./CONVE." once;
4. Turn "👉" to choose 80% microwave power till "P80" displays;
5. Press "START/+30SEC./CONFIRM" to confirm;
6. Turn "👉" to adjust the cooking time of 7 minutes;
7. Press "START/+30SEC./CONFIRM" to start cooking.

8. KITCHEN TIMER

1. In waiting state, press "KITCHEN TIMER/CLOCK" once, "00:00" displays.
2. Turn "👉" to adjust the timer. The maximum time is 95 minutes.
3. Press "START/+30SEC./CONFIRM" to confirm.

Note:

- The kitchen time is differ from 24-hour system. Kitchen Timer is a timer.
- During kitchen timer, any program cannot be set. The timer can be stopped by pressing "STOP/CLEAR".

9. SPEEDY COOKING

1. In waiting state, press "START/+30SEC./CONFIRM" key to cook with 100% power level for 30 seconds. Each press on the same key can increase 30 seconds. The maximum cooking time is 95 minutes.
2. In waiting state, turn "👉" left to choose cooking time directly then press "START/+30SEC./CONFIRM" key to cook with 100% microwave power.



10. DEFROST BY W.T.

1. Press "WEIGHT/TIME DEFROST" pad once, the oven will display "dEF1".
2. Turn "👉" to select the weight of food. At the same time, "g" will lights. The weight should be 200-2000g.
3. Press "START/+30SEC./CONFIRM" key to start defrosting.

11. DEFROST BY TIME

1. Press "WEIGHT/TIME DEFROST" key twice, the oven will display "dEF2".
2. Turn "👉" to select the cooking time. The maximum setting time is 95 minutes.
3. Press "START/+30SEC./CONFIRM" key to start defrosting.

Note: If the food weight is no more than 200 grams, please place the food at the edge of the glass turntable but not the center to be defrosted.

12. INQUIRING FUNCTION

1. In cooking state, press "MICRO/GRILL /COMB I./CONVE.", the current power will be displayed for 2-3 seconds.
2. During cooking state, press "KITCHEN TIMER/CLOCK" to check the current time. It will be displayed for 2-3 seconds.

13. LOCK-OUT FUNCTION FOR CHILDREN

Lock: In waiting state, press "STOP/CLEAR" for 3 seconds, there will be a long "beep" denoting entering into the children-lock state and locked indicator will light. LED will display current time or 0:00.

Lock quitting: In locked state, press "STOP/CLEAR" for 3 seconds, there will be a long "beep" denoting that the lock is released, and "🔒" indicator will disappear.

14. SPECIFICATION

1. The buzzer will sound once when turning the knob at the beginning.
2. "START/+30 SEC./CONFIRM" must be pressed to continue cooking if the door is opened during cooking.
3. If the cooking programme has been set but "START/+30 SEC./CONFIRM" is not pressed in 5 minutes. The current time will be displayed. The setting will be cancelled.
4. The buzzer sounds once by efficient press, inefficient press will be no response.
5. The buzzer will sound five times to remind you when cooking is finished.



15. AUTO MENU

1. In waiting state, turn "👉" right to choose the function wanted, and "A1", "A2", "A3"... "A10" will be displayed.
2. Press "START/ +30 SEC./CONFIRM" to confirm the menu you need.
3. Turn "👉" to choose the weight of menu, and "g" indicator will light.
4. Press "START/ +30 SEC./CONFIRM" to start cooking.

Note: Cake menu is under convection cooking with 180°C warm-up function, and you should preheat first following the auto menu operation, when the oven reaches the temperature, it will stop working and sound to remind opening the door to put the cake in, then press "START/+30SEC./CONFIRM" to start cooking.

- To roast chicken and frozen pizza, the food should be placed on the 40mm height rack.
- To toast menu, the food should be placed on the 95mm height rack.

MENU	WEIGHT (G)	DISPLAY	POWER
A1 VEGETABLE	150 350 500	150 350 500	100%
A2 FISH	150 250 350 450 650	150 250 350 450 650	80%
A3 MEAT	150 300 450 600	150 300 450 600	100%
A4 PASTA	50 (with cold water 450g) 100 (with cold water 800g) 150 (with cold water 1200g)	50 100 150	80%
A5 POTATO	1 (approx.230g) 2 (approx.460g) 3 (approx.690g)	1 2 3	100%
A6 SOUP	200ml 400ml 600ml	200 400 600	100%
A7 ROAST CHICKEN	800 1000 1200	800 1000 1200	100% Micro/Conve. to 220°C
A8 TOAST	50 100 150	50 100 150	Grill
A9 CAKE	475	475	Conve. to 180°C with preheat
A10 PIZZA	200 300 400	200 300 400	100% Micro/Conve. to 220°C



TROUBLE SHOOTING

NORMAL	
Microwave oven interfering with TV reception.	Radio and TV reception may be interfered when the microwave oven is operating. It is similar to the interference of small electrical appliances, like a mixer, vacuum cleaner and electric fan. It is normal.
Dim oven light.	In low power microwave cooking, the oven light may become dim. It is normal.
Steam accumulating on door, hot air out of vents.	In cooking, steam may come out of the food. Most will get out from the vents. But some may accumulate on a cool place like the oven door. It is normal.
Oven started accidentally with no food in.	It is forbidden to run the unit without any food inside. It is very dangerous.

TROUBLE	POSSIBLE CAUSE	REMEDY
Oven can not be started.	Power cord not plugged in tightly.	Unplug. Then plug in again after 10 seconds.
	Fuse blowing or circuit breaker work.	Replace fuse or reset circuit breaker (repaired by professional personnel of our company).
	Trouble with outlet.	Test outlet with other electrical appliances.
Oven does not heat.	Door not closed well.	Close door well.
Glass turntable makes a noise when microwave oven operates.	Dirty roller rest and oven bottom.	Refer to "Maintenance of Microwave" to clean dirty parts.



The packaging materials that are used are environmentally friendly and can be recycled.

Please discard all packaging material with due regard for the environment.

This appliance is marked according to the European directive 2002/96/EC for Waste Electrical and Electronic Equipment (WEEE). By ensuring this product is disposed of correctly, you will help prevent potential negative consequences for the environment and human health, which could otherwise be caused by inappropriate waste handling of this product.

The symbol on the product, or on the documents accompanying the product, indicates that this appliance may not be treated as household waste. Instead, it shall be handed over to the applicable collection point for the recycling of electrical and electronic equipment.

Disposal must be carried out in accordance with local environmental regulations for waste disposal. For more detailed information about treatment, recovery and recycling of this product, please contact your local city office, your household waste disposal service or the shop where you purchased the product.



NOTE: Model number and details are to be recorded below for future reference.
Please have the following information ready before calling our customer care team.

FURTHER INFORMATION

It is a warranty requirement that proof of purchase must be provided when booking a service call.
Please be advised that without this proof of purchase, your warranty may not be honoured.

All warranty will be voided, if not installed by a licensed technician or tradesman.

Please record their details below for future reference:

TECHNICAN / TRADESMAN WHO INSTALLED:

.....

LICENSE NUMBER:

DATE OF INSTALLATION:.....

INSTALLATION RECEIPT NUMBER:.....

If you require more information, service, warranty or spare parts enquiries
please contact customer care.

DANIELA APPLIANCES PTY LTD
(02) 9604 1226 (9am – 5pm EST, Monday – Friday)

TERMS AND CONDITIONS

TERMS OF WARRANTY

Daniela appliances warrants to the original purchaser of appliance providing the product is installed specifically for their intended use, under proper care, domestic/residential use and maintenance of the products supplied by Daniela appliances, will be free from defects in workmanship and materials subject to the terms and conditions to follow.

Daniela Appliances warranty only applies to the original owner and is not transferable. Our warranty covers rectification free of charge for any faults arising from defective materials or components and faulty workmanship. The product will be repaired or replaced at the discretion of Daniela Appliances.

NOTE: All costs of installation, stone benchtop replacement, cabinetry replacement or repair, sink/tapware removal, un-installation, cartage, freight, travelling expenses and insurance are to be paid by the customer.

RETURN POLICY

Kindly inspect your goods at time of delivery.

If you notice any damage to your goods please notify our delivery team at the time of delivery. Recommend you thoroughly inspect your goods at this time. If you notice any damage to your goods please call with in 24 hours of receiving delivery, please notify Daniela Appliances Pty Ltd immediately. Evidence of damage will be required.

If for any reason you need to return an item please call Daniela Appliances Pty Ltd on (02)9604-1226, within 48 hours of receiving the goods or appliances.

If your goods remain boxed and in an unopened condition, they may be returned with in 30 days of the invoice date for a full refund. A collection fee of \$50 will be charged should you require Daniela Appliances Pty Ltd to collect the stock.

If your goods have been unboxed but otherwise are in as new condition (Have not been used or connected) a 20% restocking fee (20% of the purchase price) will apply.

Daniela Appliances Pty Ltd DOES NOT DEAL WITH FACTORY SECONDS, DAMAGES OR OPENED GOODS, and charges restocking fees to cover the return costs. A collection fee of \$50 or the delivery charge if greater than the \$50 will apply.

Please note that if you request connection of your appliance, Daniela Appliances Pty Ltd will unbox the product at the time of delivery. We recommend you inspect your goods thoroughly at time of delivery, as to avoid extra charges.

Return of goods are to be covered by the customer, or alternatively can be returned in person to Daniela Appliances Pty Ltd, at no extra charge. Please note that a collection fee of \$50 or greater will be charged should you wish Daniela Appliances Pty Ltd, to collect the stock on your behalf.

You as a customer have a duty of care for the product whilst in your possession. If products are damaged by you, and subsequently returned, a charge will be made to repair the product to its original condition. Please be aware that where repair is economically viable, no refund will be given.

All refunds will be issued when goods arrive back to Daniela Appliances warehouse and have been inspected by a staff member of our team. Refunds will be made by the same method used for purchase. We are unable to accept returns of any goods that you have attempted to install or have used.

If there are any further queries, please don't hesitate to contact Daniela Appliances Pty Ltd on (02) 9604 1226.

THANK YOU.



Daniela
Appliances

P | 02 9604 1226 E | sales@danielaappliances.com.au A | 6/9 Hume Road, Smithfield NSW 2164

danielaappliances.com.au