



DAN-1021BU

NICKEL PULL OUT MIXER

Product



Features

- Kitchen tap with detachable spray
- Premium brass construction
- Brushed Nickel finish
- Hot & cold water flow flicking mixer
- WELS Star Rating: 6 Star, 4L/M
- 35mm Kerox ceramic cartridge
- Easy to install
- 10 years replacement products and parts.
- 2 years labour.

Accessories Included

- Set of mounting accessories

Power Specifications

Pressure rating: Maximum operating pressure 1000kPa. Note: For best performance and longer life we recommend 300-800kPa
 Temperature rating: Maximum hot temperature 80°C, minimum 5°C

Dimensions

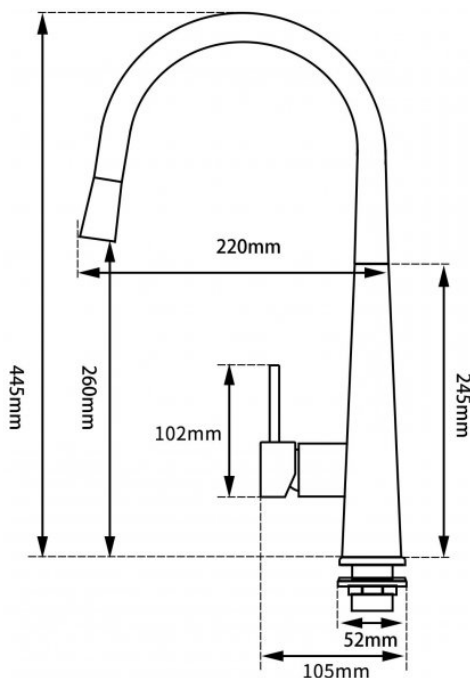

Product Dimensions

445mmH x 220mmW

Installation Information

A suitably qualified plumber is required for installation. It is suitable that this tap is installed directly through a solid bench top or a top mounted sink.

Please note:

Dimensions and specifications are a guide only refer to the instruction manual for full instructions. Every effort has been made to ensure this information is correct. However, due to product improvement Daniela Appliances reserves the right to make changes to products without prior notice.