

Daniela



DAN6SO
60CM DUCTED SLIDEOUT RANGEHOOD
Appliance User Manual

danielaappliances.com.au



Daniela Appliances started in 1988. Formally known as Italnova, the company began operating by selling other major leading brands. Since then, Daniela Appliances has its own range, continuously evolving, striving on delivering leading-edge quality products at very competitive prices.

From an Italian heritage our brand Daniela was then established in 2005 from a father's love to a daughter and naming it after Daniela, now the new proprietor. Daniela has worked closely with her father for many years learning from his decades of industry experience. Daniela with her extensive knowledge and understanding of appliances, now continues her father's legacy with a modern flare.

Our products are extensively tested and come with ISO certification certificates prior to importation. Daniela Appliances continuously designs and sources the best parts, to bring you an elegant feel that will last the test of time and for a third of the cost from a major brand.

Daniela Appliances is dedicated to offering our customers exceptional products with exceptional service. Our commitment is to provide our valuable customers the very best in technology with the very best in safety that combines both the values that brings us market success.



DAN6SO

60CM DUCTED SLIDEOUT RANGEHOOD

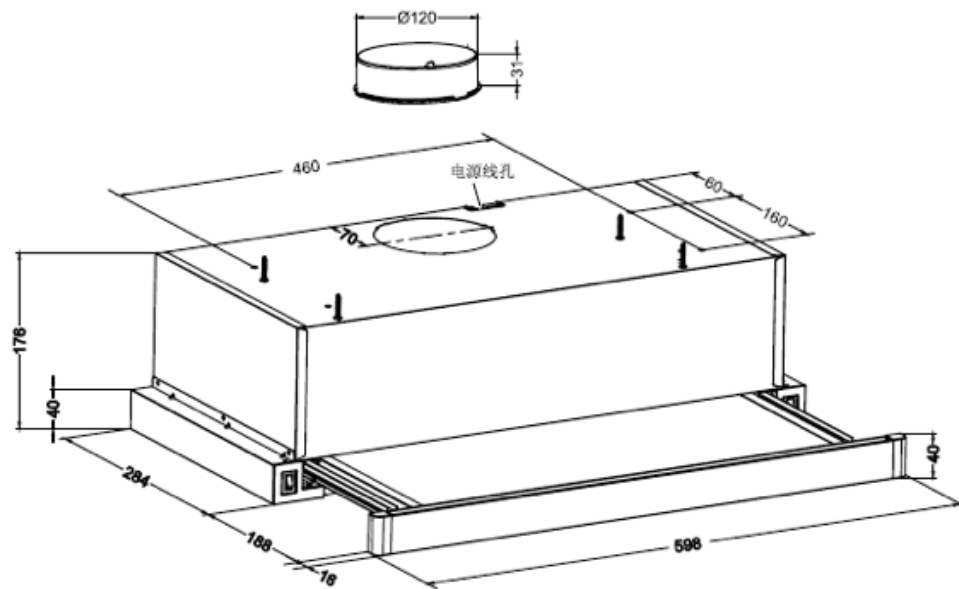

MODEL	DAN6SO
Venting Type	Ducting
Rated Voltage	230V
Rated Power Frequency	50Hz
Light Power	2 X 2W
Motor Power	2 X 120W
Total Power	244W
Motor	2
Diameter of Outlet Adapter	120mm
Dimension (mm)	W598 x D488 x H176



SAVE THIS INSTRUCTION IN A SAFE PLACE FOR FUTURE REFERENCE

Thank you for choosing Daniela appliances!

Please read all instructions before using this appliance. This book contains valuable information about operation, care and service. Keep it in a safe place for future reference. Should the appliance be sold or transferred to another owner, or should you move house and leave the appliance, always ensure that the book is supplied with the appliance in order that new owner can be acquainted with the functioning of the appliance and relevant warnings.

The manufacturer cannot be held responsible for any inaccuracies due to printing or transcription errors that may be found in this handbook.

N.B.: the pictures shown in the figures in this handbook are purely indicative.

RECOMMENDATIONS AND SUGGESTIONS

- Daniela Appliances Pty Ltd will not be held liable for any damages resulting from incorrect or improper installation.
- Please read this instruction manual before installing and using this range hood. Please keep this instruction manual in a safe place for future reference.
- Only a qualified and trained service technician can undertake the work of installation and servicing.
- Check that the main voltage corresponds to the one indicated on the rating plate fixed inside the hood.
- Do not connect the hood to exhaust ducts carrying combustion fumes (boilers, fire places, etc.).
- If the hood is used in conjunction with non-electrical appliances (e. g. gas burning appliances), a sufficient degree of ventilation must be guaranteed in the room in order to prevent the backflow of exhaust gas. The kitchen must have an opening directly with the open air in order to guarantee the entry of clean air.
- The minimum distance is 750mm from the range hood to a gas hob, and is 650mm to an electric hob. If the installation instructions for gas hobs specify a greater distance, this must be taken into account.



WARNING

TWO OR MORE PEOPLE ARE REQUIRED TO INSTALL OR MOVE THIS APPLIANCE. FAILURE IN DOING SO CAN CAUSE PHYSICAL HARM OR INJURIES.

- The range hood has been designed only for domestic use to eliminate kitchen fumes.
- Never use the hood for purposes other than what it has been designed for.
- Never leave high naked flames under the hood when it is in operation.
- Adjust the flame intensity to direct it onto the bottom of the pan only; making sure that it does not engulf the pan sides.
- Deep fat fryers must be continuously monitored during use: overheated oil can burst into flames.

MAINTENANCE

- Proper maintenance of the range hood will assure proper performance of the unit.
- Disconnect the hood from the main supply before carrying out any maintenance work.
- Clean and/or replace aluminium grease filters and activated charcoal filters after specified period of time.
- Clean the hood using a damp cloth and a neutral liquid detergent.
- Aluminium and charcoal filters are not covered under warranty.
- Light bulbs are not covered under warranty.
- Clean the hood using a damp cloth and neutral liquid soap.

WARNING!

Under certain circumstances electrical appliances may be a dangerous hazard.

- **Do not** check the status of the filters while the range hood is operating.
- **Do not** touch the light bulbs after appliance use.
- **Do not** disconnect the appliance with wet hands.
- **Avoid** free flame, as it can do damage to the filters from a fire hazard.
- **Constantly check** food frying to avoid that the overheated oil may become a fire hazard
- **Disconnect** the electrical plug prior to any maintenance or servicing.
- Children don't recognize the risks of electrical appliances. Therefore, use or keep the appliance only **under supervision** of adults and out of the reach from children.



WARNING!

- **Do not use** this product outdoors.
- This appliance is **not intended** for use by persons (including children) with reduced physical, sensory or mental capabilities, or lack of experience and knowledge, unless they have been given supervision or instruction, concerning use of the appliance by a person responsible for their safety. Children should be supervised to ensure that they do not play with the appliance.
- There should be **adequate ventilation** of the room when the range hood is used at the same time as appliances burning gas or other fuels.
- There is a fire risk if cleaning is not carried out in accordance with instructions.
- **Do not** flambé under the range hood
- The exhaust air must not be discharged into a flue which is used for exhausting fumes from appliances burning gas or other fuels.

ELECTRICAL SHOCK HAZARD AND FIRE

TO REDUCE THE RISK OF FIRE, ELECTRIC SHOCK, OR INJURY TO PERSONS, OBSERVE THE FOLLOWING:

- A. Installation work and electrical wiring must be done by qualified person(s) in accordance with all applicable codes and standards, including fire-rated construction.
- B. Sufficient air is needed for proper combustion and exhausting of gases through the flue (chimney) of fuel burning equipment to prevent back drafting.
- C. When cutting or drilling into wall or ceiling, do not damage electrical wiring and other hidden utilities.
- D. Ducted fans must always be vented to the outdoors.

OPERATION OF CONTROLS

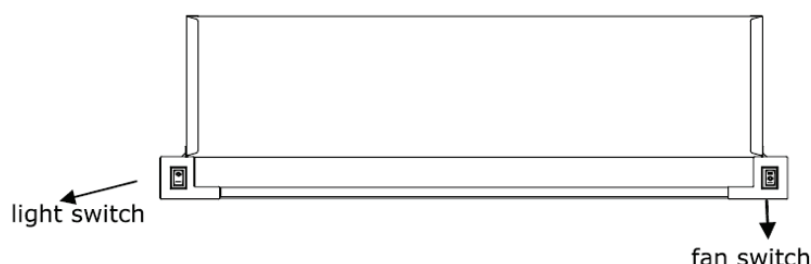

The hood is operated by using the rock switch on the front panel.

The light switch turns the light on and off.

The fan switch turns the fan on to two speed settings.



INSTALLATION & USE

INSTALLATION

- Before beginning installation, to better handle the hood, we advise removing the aluminium filter.
- Before fixing, the outlet exhaust duct for air evacuation to the outside must be installed.

Use an outlet exhaust duct with:

- Minimum indispensable length
- Minimum possible bends, please note that for every bend in your ducting you will lose 100m3 of extraction
- Maximum angle of bend is 90 deg.
- Certified material (according to local building and fire regulations), and as smooth as possible on the inside.
- It is advisable to avoid any drastic changes in duct cross-section (recommended diameter 125mm).
- Decide on the position of the hole for the air outlet. The hole must be in the ceiling, according to your requirements, but must be in vertical line with your hood. Bear in mind that the hood can expel air through the top air outlet only.

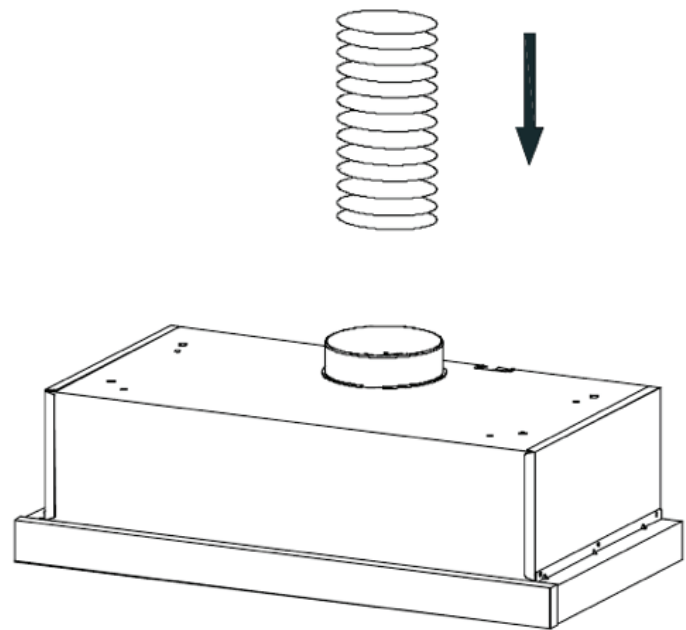

INSTALLATION OF ELECTRICAL

- The electrical wiring must be done by a qualified technician in accordance with all applicable codes and standards.
- Turn off electrical power at the service entrance before wiring.
- If the supply cord is damaged, it must be replaced by the manufacturer or a Daniela Appliances Pty Ltd service agent, to avoid a hazard.
- Do not use the plug and an extension cord other than the ones initially supplied with the hood.



CAUTION WITH INSTALLATION

- To reduce the risk of fire, the use of metal duct work is preferred.
- Do not use flammable material to convey exhaust air.
- Decide where the duct work will run between the hood and the outside.
- A straight and short duct run will allow the hood to perform most efficiently.
- Long duct runs, elbows and transitions will reduce the performance of the hood. Use as few of them as possible. Larger ducting may be required for best performance with longer duct runs.
- Attach an adequate length of 125mm round duct to the air outlet adapter.
- The air must not be discharged into a flue that is used for exhausting fume from appliances burning gas or other fuels. Regulations concerning the discharge of air have to be followed. Check with the local authority and building codes for exhaust ducting requirements.
- Install a roof/wall cap. Connect round metal ductwork to cap and work back towards hood location.

FITTING UNDER WALL UNIT

1. Before fixing the hood to the wall unit, drill a hole of 130mm diameter in the wall unit.
2. In any case, check the position of the power outlet and consider where the power cable will run, since the hole might have to be made in the wall unit to accommodate it.
3. Drill 4 holes into the wall unit, respecting the distance indicated. Push the hood up against the wall unit and insert the 4 screws operating from inside the wall unit.
4. Make the electrical connection.

MAINTENANCE

ALUMINIUM GREASE FILTERS

The grease filters should be cleaned frequently. Approx. every 2 months of operation, or more frequently for heavy use.

- Use warm water and dishwashing liquid to clean.
- Ensure they are completely dry before re-installing and using.
- Not recommended for cleaning dishwasher.
- Avoid caustic or powerful cleaning solutions.

LAMPS

This range hood requires 2 LED lamps (2W each).

NOTE: LIGHT BULBS/LAMPS ARE NOT COVERED UNDER THE 24-MONTH WARRANTY.

PAGE 8



TROUBLESHOOTING

SYMPTOMS	POSSIBLE CAUSE	ACTION
Does not function	No electrical supply	Check if the plug is connected. Check if the main switch is turned on.
Poor airflow	Aluminum filters grease clogged	Clean the filters and replace when it is dry
	Carbon filters clogged	Replace carbon filters with new sets
Motor running but no airflow	Butterfly valve jammed	Contact technician
Strong cooking smell	Carbon filter is not installed	To install the carbon filter
	Carbon filters clogged	Replace carbon filters with new sets
Oil dripping onto stove	Aluminum filters saturated	Wash the aluminum filters
	Aluminum filters saturated	Replace the aluminum filters with new sets
Whirring sound	Foreign object in contact with fan blade	Contact technician

This symbol on the product or in the instruction manual means that your electrical and electronic equipment should be disposed at the end of its life separately from your household waste. There are separate collection systems for recycling in the EU. For more information, please contact your local authority or the retailer where you purchased the appliance.



When you unpack the appliance, make sure that it has not been damaged in any way. If you have any doubts at all DO NOT INSTALL OR USE THE APPLIANCE. In this instance please contact your retailer or Daniela Appliances direct. Keep packing material such as plastic bags, polystyrene, nails or screws out of the reach of children, as they are a choking hazard.



FURTHER INFORMATION

It is a warranty requirement that proof of purchase must be provided when booking a service call. Please be advised that without this proof of purchase, your warranty may not be honoured.

All warranty will be voided, if not installed by a licensed technician or tradesman.

Please record their details below for future reference:

TECHNICAN / TRADESMAN WHO INSTALLED:

.....

LICENSE NUMBER:

DATE OF INSTALLATION:.....

INSTALLATION RECEIPT NUMBER:.....

If you require more information, service, warranty or spare parts enquiries please contact customer care.

DANIELA APPLIANCES PTY LTD
(02) 9604 1226 (9am – 5pm EST, Monday – Friday)

.....
NOTE: Model number and details are to be recorded below for future reference.
Please have the following information ready before calling our customer care team.
.....

Model number:.....

Serial number:.....

Place of purchase:.....

Date of purchase (NOT Installation):

Receipt or Invoice Number:.....



TERMS AND CONDITIONS

TERMS OF WARRANTY

Daniela appliances warrants to the original purchaser of appliance providing the product is installed specifically for their intended use, under proper care, domestic/residential use and maintenance of the products supplied by Daniela appliances, will be free from defects in workmanship and materials subject to the terms and conditions to follow.

Daniela Appliances warranty only applies to the original owner and is not transferable.

Our warranty covers rectification free of charge for any faults arising from defective materials or components and faulty workmanship. The product will be repaired or replaced at the discretion of Daniela Appliances.

NOTE: All costs of installation, stone benchtop replacement, cabinetry replacement or repair, sink/tapware removal, un-installation, cartage, freight, travelling expenses and insurance are to be paid by the customer.

RETURN POLICY

Kindly inspect your goods at time of delivery.

If you notice any damage to your goods please notify our delivery team at the time of delivery. Recommend you thoroughly inspect your goods at this time. If you notice any damage to your goods please call within 24 hours of receiving delivery, please notify Daniela Appliances Pty Ltd immediately. Evidence of damage will be required.

If for any reason you need to return an item please call Daniela Appliances Pty Ltd on (02) 9604-1226, within 48 hours of receiving the goods or appliances.

If your goods remain boxed and in an unopened condition, they may be returned within 30 days of the invoice date for a full refund. A collection fee of \$50 will be charged should you require Daniela Appliances Pty Ltd to collect the stock.

If your goods have been unboxed but otherwise are in as new condition (Have not been used or connected) a 20% restocking fee (20% of the purchase price) will apply.

Daniela Appliances Pty Ltd DOES NOT DEAL WITH FACTORY SECONDS, DAMAGES OR OPENED GOODS, and charges restocking fees to cover the return costs. A collection fee of \$50 or the delivery charge if greater than the \$50 will apply.

Please note that if you request connection of your appliance, Daniela Appliances Pty Ltd will unbox the product at the time of delivery. We recommend you inspect your goods thoroughly at time of delivery, as to avoid extra charges.

Return of goods are to be covered by the customer, or alternatively can be returned in person to Daniela Appliances Pty Ltd, at no extra charge. Please note that a collection fee of \$50 or greater will be charged should you wish Daniela Appliances Pty Ltd, to collect the stock on your behalf.

You as a customer have a duty of care for the product whilst in your possession. If products are damaged by you, and subsequently returned, a charge will be made to repair the product to its original condition. Please be aware that where repair is economically viable, no refund will be given.

All refunds will be issued when goods arrive back to Daniela Appliances warehouse and have been inspected by a staff member of our team. Refunds will be made by the same method used for purchase.

We are unable to accept returns of any goods that you have attempted to install or have used.

If there are any further queries, please don't hesitate to contact Daniela Appliances Pty Ltd on (02) 9604-1226.

THANK YOU.



Daniela
Appliances

P | 02 9604 1226 E | sales@danielaappliances.com.au A | 8/10 Hume Road, Smithfield NSW 2164

danielaappliances.com.au